



---

**Breathe...**

# Automobile Pollution Test



CO VALUE

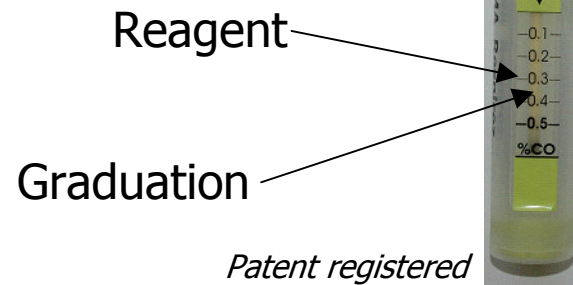
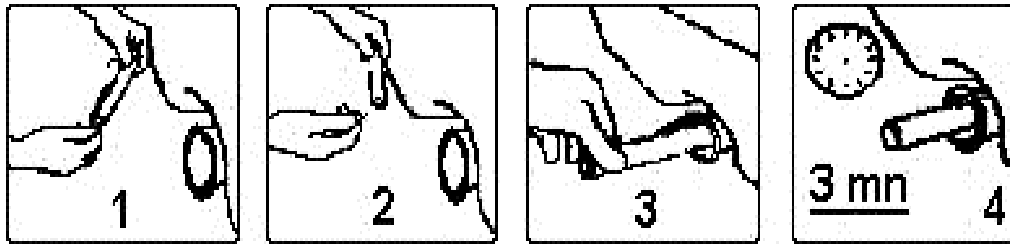

## Use conditions :

1. Stand near the exit pipe
2. Take off the little cork
3. Stick directly the test into the exhaust pipe
4. Wait for 3min.... Read the result.



Copyright © Journal de l'Automobile

# RELIABILITY

U.S.T.L Realisation (University of Sciences and Technologies of Lille )

The tests have enabled to compare the A.P.T accuracy with the infrared ghost which has a legislative value.

The curves show that the relation between the two parameters are really linear.

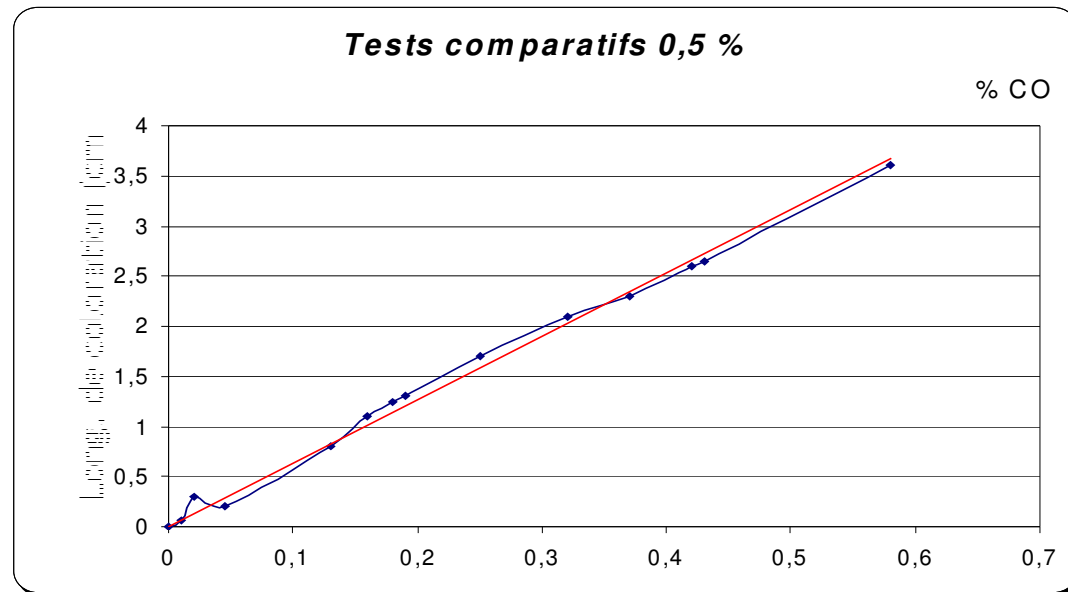

Tests realized on Renault Twingo, Mégane, Clio, Peugeot 206, 306, 205, Ford Ka, Escort, Fiesta, Opel Vectra, Seat Ibiza, ...).

# T.P.A. : Petrol version + G.P.L.



- ✓ Individual box
- ✓ Can be recycled
- ✓ Delivered "all in"
- ✓ Reliable and inexpensive

## Informative Guide

**AVANT TOUTE UTILISATION**

- ✓ Assurez-vous avant toute utilisation que le test est bien installé et que le véhicule est correctement préparé.
- ✓ L'absence de cette notice est un signe que le test n'est pas conforme et qu'il ne doit pas être utilisé.

**Préparation de l'essai**

1. Vérifier le niveau de l'huile moteur.
2. Vérifier le niveau de l'eau dans le réservoir.
3. Vérifier le niveau de l'essence dans le réservoir.
4. Vérifier le niveau de l'air dans le réservoir.

**Précautions à prendre**

Le test de pollution automobile est un test de mesure de la pollution automobile. Il est effectué dans un environnement contrôlé et sécurisé. Les résultats du test sont utilisés pour évaluer la pollution automobile et pour déterminer les mesures à prendre pour réduire la pollution automobile.

**Type de véhicules**

Type de véhicules	Niveau de pollution	Niveau de CO2 (g/km)
Essence	-0.1	100
Essence	-0.2	120
Essence	-0.3	140
Essence	-0.4	160
Essence	-0.5	180
Essence	-0.6	200



## For the professionals...

- ✓ Propose a supplementary benefit before control : integration of the cost in a « maintenance pack ».
  - ✓ Complete a range of products for your customers by answering to a current preoccupation.
  - ✓ Do associated sales (for example : motor-fuel additives).
  - ✓ To allow to preserve a bond with the car driver (tool of development of consumer loyalty)
- 

## For publics Communities...

- Better followed automobile park gasoline and G.P.L.
- Simple and reliable tool allowing to a “environmental communication”, more easier for the general public.
- Innovating product whith an important “notoriety capital”.
- Prevention of automobile pollution without heavy investments (National Police,...).

## For the Car drivers...

- **Control before buying a second-hand vehicle.**

State of the system of depollution (catalytic pot, probe lambda...).

If you want to buy a second hand car, it can be useful to make a fast car pollution test, efficient and reliable to secure your investment.

Indeed, if the test reacts, it is because of one or more mechanic problem(s).

Pollution is a good indicator of the state of the vehicle.

It is a decisive tool to buy a second hand car!

- Prevents from spending 500 to 1500 € in repairs like replacing the muffler, etc.
- Best negotiation when buying the car, it is a reliable proof of a pollution default.
- Brings a reliable indication when buying the car. Indeed, the car can be used up to 6 monthes between the technical control and when it is sold.
- Secures your purchase for less money

- **Environmental citizen act**

## Automobile Pollution Test is able to...

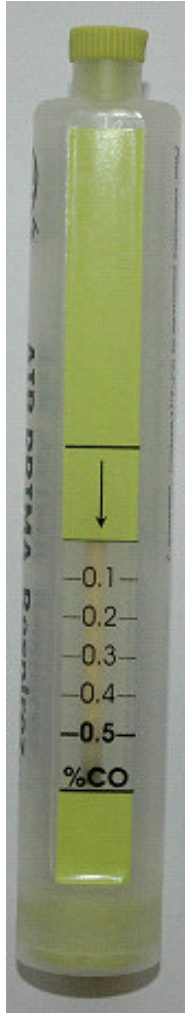

- ✓ Supervise the correct operation for the system of depollution
- ✓ To follow the level of consumption
- ✓ To make safe the vehicle inspection
- ✓ To make safe controls of the antipollution brigades policies
- ✓ To prevent automobile pollution

## Contacts



Parc Scientifique Haute Borne / Centre Innovation C.I.E.L.

5 rue Héloïse

59650 VILLENEUVE D'ASCQ

Nicolas TRIKI

Tél. : +33 328 76 14 86

Mobile : +33 661 99 50 50

[contact@air-prima.com](mailto:contact@air-prima.com)

[www.air-prima.com](http://www.air-prima.com)

---

**Breathe...**